

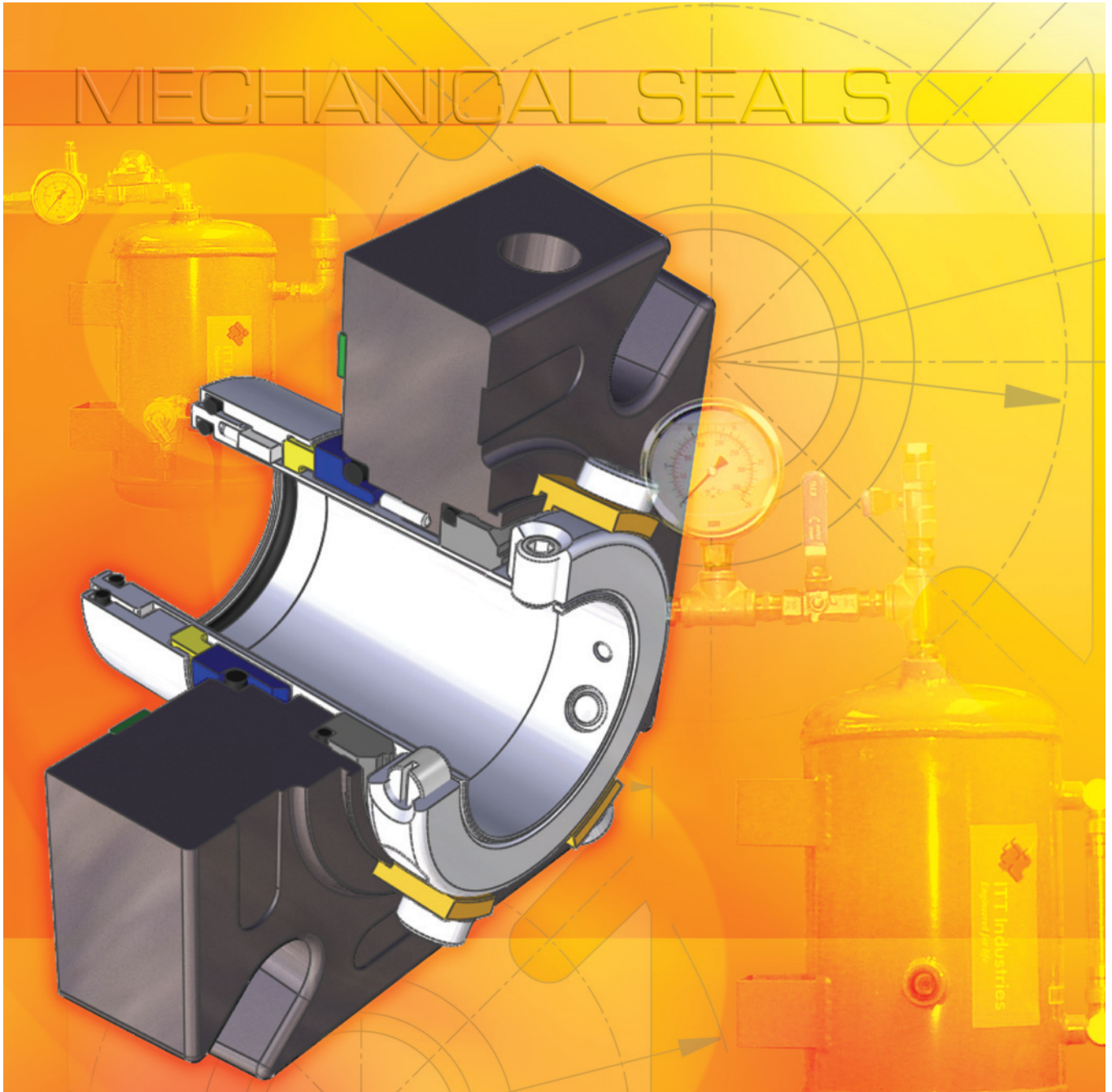

SealPlus™ Mechanical Seals



Goulds Pumps



ITT Industries
Engineered for life



Seal Plus SP1 Single and SP2 Double Mechanical Seals

The Logical Alternative to Component Seals

Maximum Operating Pressure @
3600 rpm: 300 psi @ 20°F (-5°C)
Maximum Operating
Temperature: 400°F (205°C)

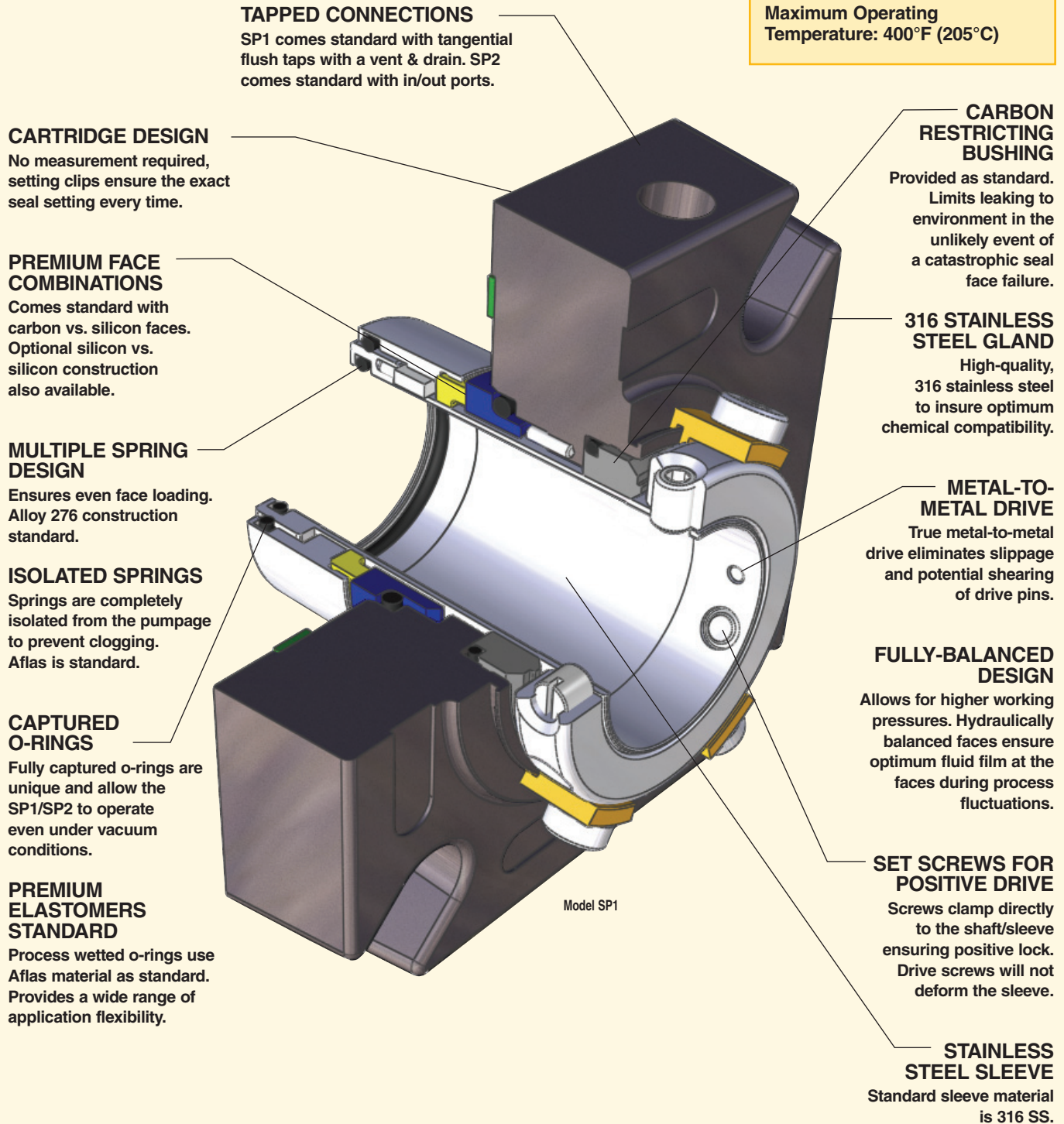

When Ease of Maintenance and Reliability Rule...

For years, conventional mechanical seals have been used in applications where, often due to cost, cartridge seals were prohibitive. Goulds Seal *Plus* SP1 and SP2 are

changing all that! From the company you trust for the best process pumps in the industry, look to Goulds now for the most economical and reliable seal alternatives.

Sectional View SP1

Enlarged Bore

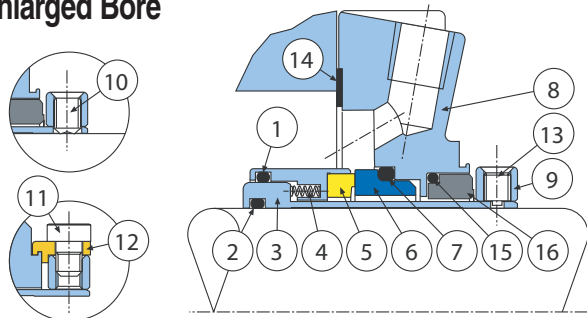

Standard Bore

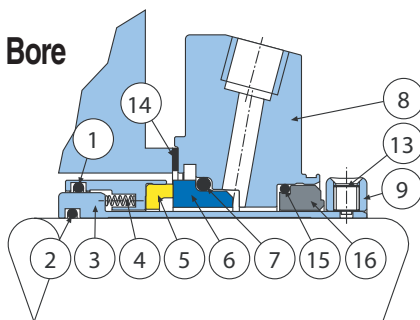

SP1 Parts List and Materials of Construction

Item	Description	Material
1	Rotary O Ring	Aflas® 100
2	Sleeve O Ring	Aflas® 100
3	Sleeve	316L Stainless Steel
4	Springs	Alloy 276
5	Rotary Face	Carbon or SiC
6	Stationary Face	SiC
7	Stationary O Ring	Aflas® 100
8	Gland	316 Stainless Steel
9	Clamp Ring	316L Stainless Steel
10	Drive Screws	Stainless Steel
11	Clip Screws	Stainless Steel
12	Setting Clips	Brass
13	Anti-tamper Screws	Stainless Steel
14	Gasket	AF1 / GFT
15	Restriction Device O Ring	EPR
16	Restriction Device	Carbon

All Tapped Connections are 1/4" NPT

Sectional View SP2

Standard Bore

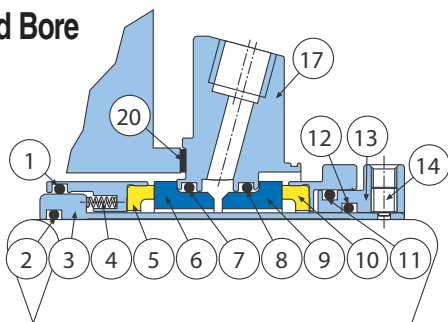

Enlarged Bore

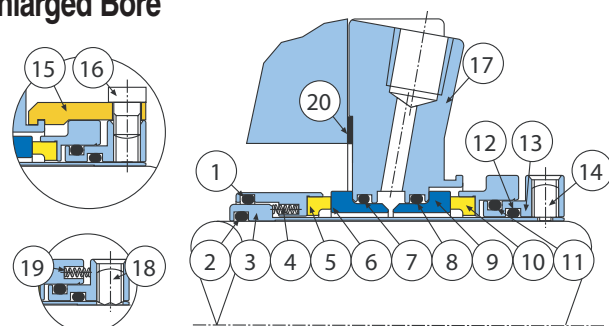

SP2 Parts List and Materials of Construction

Item	Description	Material
1	Rotary O Ring	Aflas® 100
2	Sleeve O Ring	Aflas® 100
3	Sleeve	316L Stainless Steel
4	Springs	Alloy 276
5	Inner Rotary Face	Carbon or SiC
6	Inner Stationary Face	SiC
7	Stationary O Ring	Aflas® 100
8	Stationary O Ring	Viton®
9	Outer Stationary Face	SiC
10	Outer Rotary Face	Carbon
11	Drive Band O Ring	Viton®
12	Clamp Ring O Ring	Viton®
13	Clamp Ring	316L Stainless Steel
14	Anti-tamper Screws	316 Stainless Steel
15	Centering Clips	Brass
16	Clip Screws	Stainless Steel
17	Gland	316 Stainless Steel
18	Drive Screws	Stainless Steel
19	Springs	Alloy 276
20	Gasket	AF1 / GFT

All Tapped Connections are 1/4" NPT

Viton® is a registered trademarks of Dupont Dow Elastomers.
AFLAS® is a registered trademark of the Asahi Glass Co., Ltd.

Standard Seal Flush Pot for conventional plan 52 and 53 flush plans

FILL VALVE
Allows easy
replenishment of
barrier fluid.

**GAS SUPPLY
CONNECTION**

LEVEL GAUGE
Allows monitoring
of fluid level.

DRAIN VALVE



Water Miser™ Flush Pot for use with mill water and plan 53 and plan 54 flush plans

**WATER PRESSURE
REGULATOR**
Maintains barrier
fluid pressure.

FLOW INDICATOR
Indicates seal failure.

AIR VENT VALVE
Maintains air space for
thermal expansion.

THREE-WAY VALVE
Allows pressure relief when
setting regulator, draining
of tank, and flushing of
seal and chamber without
returning flush water to
seal pot.

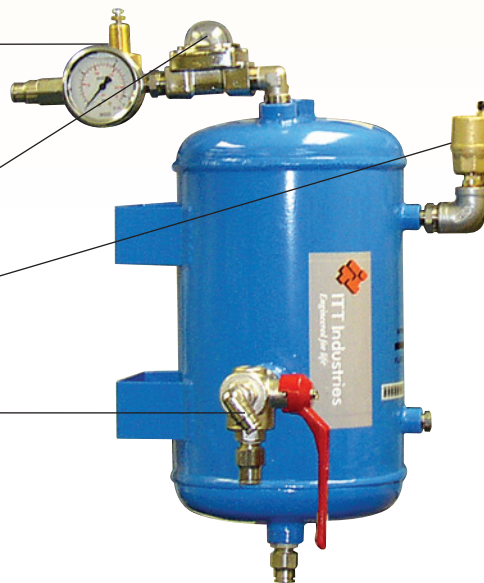

Features:

- 2.64 US gallons (10 liters) or 6.60 US gallons (25 liters) compact capacity
- 304 stainless steel construction to ASME VIII Div 1. 1995 / BS5500 CAT III. 1997
- Maximum working pressure 232 psig @ 212°F (16 barg @ 100°C). Tested to 348 psig (24 barg)
- All systems are shipped complete and fully pressure tested
- 1" (25.4mm) NPT port for top entry-level gauge
- Current and peak temperature strips fitted as standard
- Minimum fluid level indicator
- Sediment pipe on feed port prevents contamination going through the seal
- Integral mounting bracket
- High quality powder coat finish
- Internal cooling coil optional
- Push-in fittings standard with nylon hose
- Compression fittings and braided stainless lines available

Visit our website at www.gouldspumps.com

Goulds Pumps

